

MODEL 372
SERIES AI

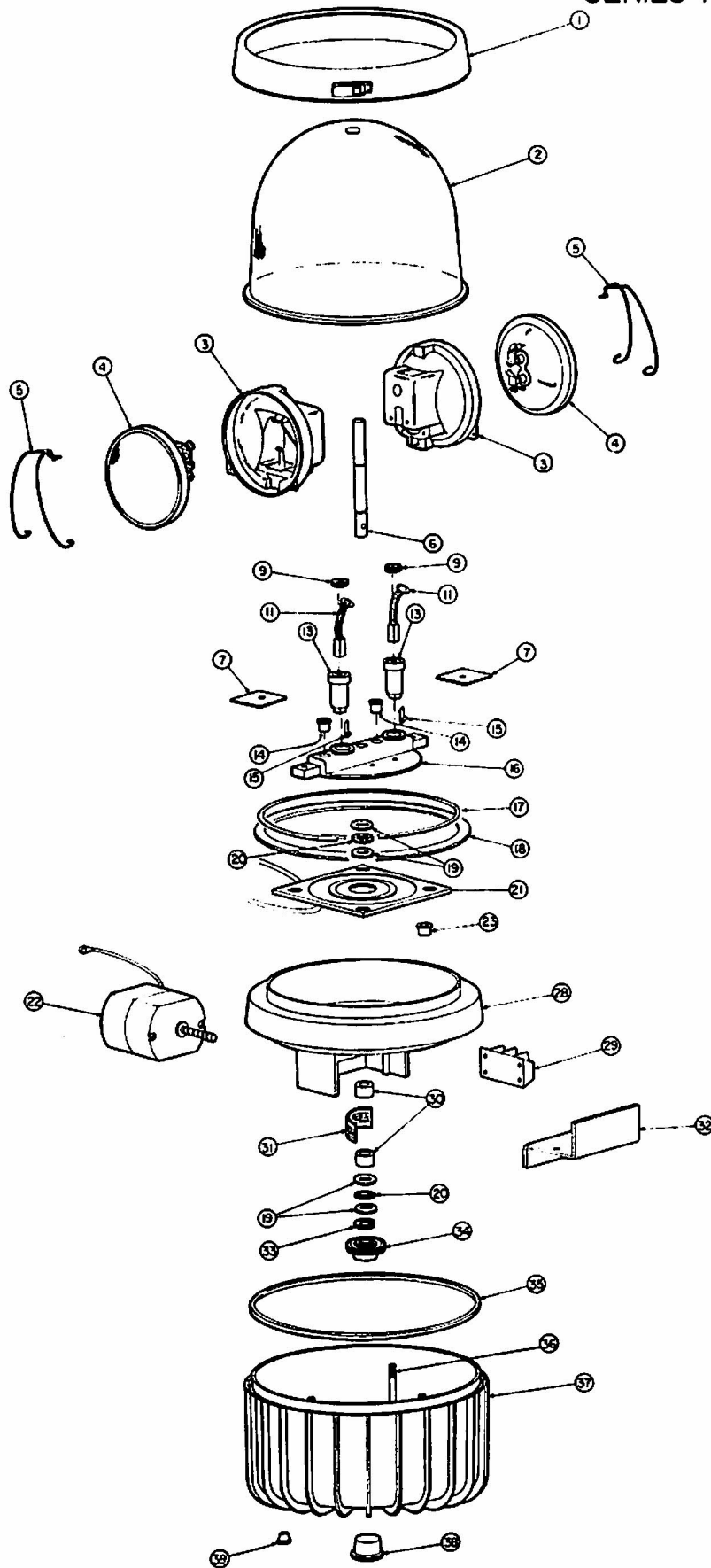

MODEL 372
SERIES AI

Index	Description	Part No.	Qty.
1	Retaining Band Assembly	8449C017	1
2	Glass Dome, Red	8442C002	1AR
	Glass Dome, Amber	8442C002-01	
	Glass Dome, Clear	8442C002-02	
	Glass Dome, Blue	8442C002-03	
	Plastic Dome, Red	8449C005-11	
	Plastic Dome, Blue	8449C005-12	
	Plastic Dome, Amber	8449C005-14	
	Plastic Dome, Clear	8449C005-15	
	Split Dome, Blue and Clear	8449C048-01	
	Split Dome, Amber and Red	8449C048-02	
	Split Dome, Red and Blue	8449C048-03	
	Split Dome, Amber and Blue	8449C048-04	
	Split Dome, Red and Clear	8449C048-05	
Split Dome, Amber and Clear	8449C048-06		
3	Lamp Holder	8449A055	2
4	Lamp (28V, 32V, and 36V lights)	8107A027	2AR
	Lamp (64V to 75V lights)	8107A055	
5	Lamp Clamp Wire	8422B016	2
6	Shaft	8459A039	1
7	Insulator (32V and 36V lights only)	8459A040	2
9	Brush Cap	8442A026	2
11	Brush and Spring	8442A028	2
13	Brush Holder	8442A025	2
14	Snap Bushing	8459A028	2
15	Brush Holder Clip	8442A027	2
16	Lamp Holder Support	8459C003	1
17	Spacer Ring for Plastic Dome	8449A040	1AR
18	Gasket for Glass Dome	8449C006-01	1AR
	Gasket for Plastic Dome	8449C006-02	
19	Thrust Washer	8449A021	4
20	Thrust Retainer	8449A022	2
21	Slip Ring Assembly	8459A012	1
22	Motor (28V, 32V, 36V lights)	8422B111-09	1AR
	Motor (64V to 75V Lights)	8422B111-10	
23	Snap Bushing	8449A010	1
28	Base Plate	8459C081	1
29	Terminal Block	8442A032	1
30	Sleeve Bearing	8240A034-01	2
31	Felt Oil Pad	8449A011	1
32	Gear Box Cover	8459B008	1
33	Retaining Ring	8422A010	2
34	Worm Gear Clutch Assembly	8422A114	1
35	Gasket	8449C007	1
36	Stud	8459A019	3
37	Housing	8459D002	1
38	Tapered Plug	8449A016	1
39	Tubing Plug	8449A014	3
Not Shown	Resistor, 5-ohm, 25 watt (32-36 VDC only)	8449A045	2AR
	Shock Mounting Conversion Kit	8459A079	
	Capacitor, 0.2UF (64-75 VDC lights only)	8170A155	2AR

Motor 12-volt

8422B111-05

Resistor 12ohm (64-75 VDC light)

8459A078

2AR